

# POLARIS OEM PRODUCTS

## Copper Neutral Bars

### TYPE: PHCNB

- \* Manufactured from high strength copper tubing
- \* Range Taking design reduces inventory
- \* For use with Copper Conductors only
- \* Rated for 600 Volts
- \* UL Listed to 90° C
- \* Standard product includes Zinc plated Steel Screws (Brass Screws also available)

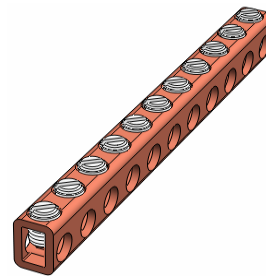
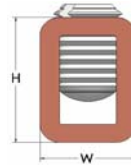
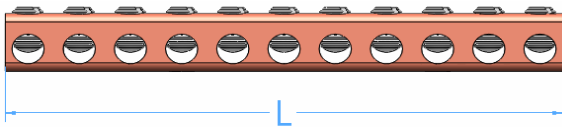

Catalog Number	Number of Circuit Taps	Number of Mounting Holes	Line Range	Circuit Range	Dimensions, Inches		
					H	W	L
PHCNB-5	4	1	4-14	4-14	0.47	0.34	2.75
PHCNB-7	5	2	4-14	4-14	0.47	0.34	3.50
PHCNB-12	10	2	4-14	4-14	0.47	0.34	4.72
PHCNB-15	13	2	4-14	4-14	0.47	0.34	5.94
PHCNB-17	15	2	4-14	4-14	0.47	0.34	6.70
PHCNB-174	174	0	4-14	4-14	0.47	0.34	72"

\*Other Mounting Configurations available, please contact factory for assistance.

\* Oxide Inhibitor is recommended for all aluminum terminations.